



# PILOT OPERATED PISTON TYPE STEAM VALVE

(Normally Close Open)

## Uflow Automation

Ankur Industrial Complex, Survey No: 275/276, Plot No: 31,

Nr. Intol Cast Pvt. Ltd. Shapar (Veraval) 360 024.

Dist: Rajkot Gujarat (INDIA).

Phone No: +91 2827 254343 | Cell: +91 89059 07070

Email: [info@uflowvalve.com](mailto:info@uflowvalve.com) | Website: [www.uflowvalve.com](http://www.uflowvalve.com)

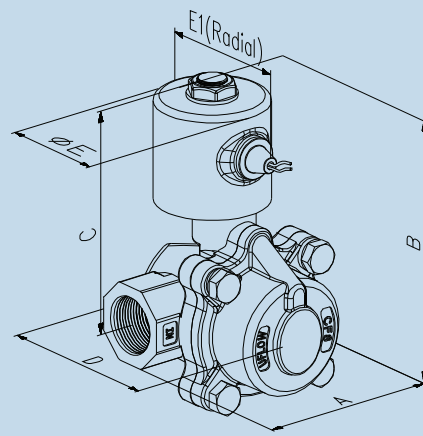
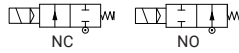

Diagram No. 13.1



## SPECIFICATIONS

Port :	Refer below technical data sheet (Available BSP / NPT)					
End Connection :	Screwed / Flange					
Body Material :	SS ASTM A351 Grade CF8 / CF8M					
Seal & 'O' Ring :	PTFE + Silicon / Viton					
Media Temp :	-10° C to 180° C					
Circumstance Temp :	-10° C to 70° C					
Media :	Steam, Hot Water, Hot Fluid, Water Oil					
Main Features :	Internal Parts are in superior corrosion resistance steel, (Equivalent to SS316L) Suitable for Food Industries, Pharmaceuticals, Chemical application & Highly corrosive environment.					
Operating Voltage :	<table border="1"> <tr> <td>24AC</td> <td>110AC</td> <td>230AC</td> <td>12DC</td> <td>24DC</td> </tr> </table>	24AC	110AC	230AC	12DC	24DC
24AC	110AC	230AC	12DC	24DC		
Power Consumption :	<table border="1"> <tr> <td>7W</td> <td>8W</td> <td>8W</td> <td>10W</td> <td>11W</td> </tr> </table>	7W	8W	8W	10W	11W
7W	8W	8W	10W	11W		
Coil Features :	High Reliability Unaffected by Voltage Surges. Easy coil changes coil lockable in 4X90 position or freely movable in between as require.					
Coil Housing :	Epoxy square coil, Metallic round enclosure, IP-67 Flame proof enclosure, IP-68 Weather proof enclosure.					
Optional Feature :	90% Power saver series also available, Manual Override, Water hammering reducer also available to avoid water hammer forces.					
Other Specification Data :	Available on Request					

**NOTE:** Use of filter in the inlet port is recommended.

## DIMENSION (NC)

All dimensions are in mm

Model No.	Port Size	Diagram No.	A	B	C	D	E	E1
HCP29	½"	13.1	67	122	94	60	44	57
HCP39	¾"	13.1	81	129.50	97	70	44	57
HCP49	1"	13.1	96	146	104	75	44	57
HCP69	1½"	13.1	108	172	117	96	44	57
HCP89	2"	13.1	132	191	125	114	44	57

In normally open valve dimension B&C will increase up to 8mm.

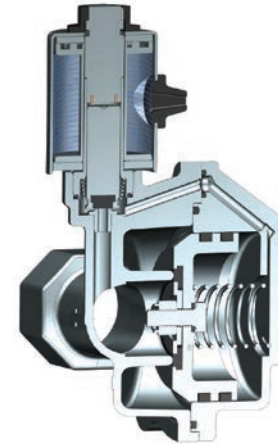

SECTION VIEW

## TECHNICAL DATA

Model No.	Body Material	Pipe (Inch)	Orifice (mm)	Min. Operating Pressure Kg/cm <sup>2</sup>	Max. Operating Pressure Kg/cm <sup>2</sup>	Seal & Diaphragm Material	Flow Factor Kv m <sup>3</sup> / hr
HCP29	CF8 / CF8M	½"	17	1.5	12	PTFE	4
HCP39	CF8 / CF8M	¾"	20	1.5	12	PTFE	7
HCP49	CF8 / CF8M	1"	25	1.5	12	PTFE	12
HCP59 / HCP69	CF8 / CF8M	1¼" / 1½"	36	1.5	12	PTFE	23
HCP89	CF8 / CF8M	2"	48	1.5	12	PTFE	38
HCP2A	CF8 / CF8M	½"	17	1.5	40	PTFE	3.50
HCP3A	CF8 / CF8M	¾"	20	1.5	40	PTFE	3.30
HCP4A	CF8 / CF8M	1"	25	1.5	40	PTFE	8.30
HCP5A / HCP6A	CF8 / CF8M	1¼" / 1½"	36	1.5	40	PTFE	17
HCP8A	CF8 / CF8M	2"	48	1.5	40	PTFE	31

# SOLENOID VALVE MODEL IDENTIFICATION CHART

**M C N 8 D 3 F -**

TYPE	
P	PILOT OPERATED
M	SEMI LIFT
J	PULSE JET
H	PISTON OPERATED
D	2WAY DIRECT ACTING
T	3WAY DIRECT ACTING
F	FAST ACTING
Y	ANGLE SEAT VALVE

SEAL MATERIAL	
N	NITRILE
E	EPDM
V	VITON
S	SILICONE
R	NEOPRINE
H	HYTREL
I	PTFE + EPDM
W	PTFE + VITON
P	PTFE + SILICONE
F	SPL. VITON

PORT SIZE	
0	1/8"
1	1/4"
2	1/2"
3	3/4"
4	1"
5	1 1/4"
6	1 1/2"
7	3/8"
8	2"
9	2 1/2"
A	3"
B	4"
C	6"

PRESSURE RANGE (MIN -MAX)	
0	0 - 350 mbar
1	0 - 500 mbar
2	0 - 2 bar
3	0 - 7 bar
4	0 - 10 bar
5	0 - 16 bar
6	0.3 - 10 bar
7	0.5 - 8.5 bar
8	0.5 - 12 bar
9	1.5 - 12 bar
A	1.5 - 40 bar
B	0 - 25 bar
C	0 - 150 bar
D	0 - 4 bar
E	0 - 3 bar
F	0 - 1 bar
G	1 - 20 bar
H	0 - 60 bar
J	0 - 40 bar
K	0 - 5 bar
L	0 - 100 bar

PLUNGER DIA	
Blank	14 mm
0	10 mm
2	16 mm
3	18 mm
4	08 mm
5	28 mm
8	30 mm

VALVE POSITION	
Blank	NC
Z	NO
M	MANUALLY OVERRIDE
S	MUFFLER

BODY MATERIAL	
C	CF8 / SS304
M	CF8M / SS316
L	CF3M / SS316L
B	BRASS
A	ALUMINIUM
N	NYLON
P	PLASTIC

PORT CONNECTION	
Blank	BSP
N	NPT
F	FLANGE
T	TRI-CLAMP
C	CUSTOMISED MOUNTING

## MCN8D3F

2" UMD DIAPHRAGM SOLENOID VALVE WITH FLANGE (0 - 4KG) (18MM)